

4" ROUND TAPERED ALUMINUM POLE

NPT40 SERIES FREE STANDING 4"Ø ALUMINUM POLES
 MAXIMUM HEIGHT 20 FT.
 3" X 5" HAND HOLE C/W GROUND LUG
 FINISH: ROTARY POLISH OR POWDERCOATED

ORDERING EXAMPLE: NPT4030C15AB
 NPT-ROUND TAPERED SERIES
 40-DIAMETER AT BASE IS 5 INCHES
 30-DIAMETER AT TOP IS 3 INCHES
 C - WALL THICKNESS IS .188
 15 - POLE IS 15 FEET HIGH
 AB-CAST ALUMINUM BASE (DB - DIRECT BURIAL)

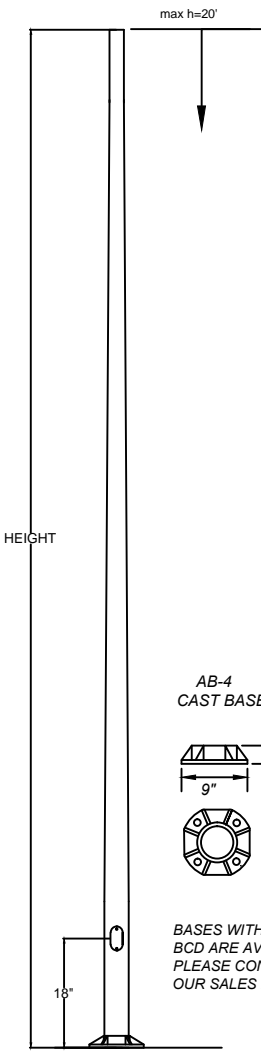

NPT 40 SERIES POLES

EPA (MPH) recommend to not exceed

WALL THICKNESS	20' @ POLE TOP				100	110	130	150
	LENGTH	BUTT DIAM	TOP DIAM.	TOP DIAM.				
0.25	20'	4"	4" - 3"	3.5	2.5	1	N/A	
0.188	20'	4"	4" - 3"	2	1	N/A	N/A	

15' @ POLE TOP

WALL THICKNESS	15' @ POLE TOP				6.5	5	3	2
	LENGTH	BUTT DIAM	TOP DIAM.	TOP DIAM.				
0.25	15'	4"	4" - 3"	6.5	5	3	2	
0.188	15'	4"	4" - 3"	4.5	3.5	2	1	

10' @ POLE TOP

WALL THICKNESS	10' @ POLE TOP				14	11.5	7.5	5.5
	LENGTH	BUTT DIAM	TOP DIAM.	TOP DIAM.				
0.25	10'	4"	4" - 3"	14	11.5	7.5	5.5	
0.188	10'	4"	4" - 3"	10.5	8.5	5.5	4	

STANDARD POLE SUPPLIED WITH-

- GROUND BAR & LUG
- NUT COVERS

OPTIONS (AS AVAILABLE)

- POWDERCOAT
- ANCHOR BOLTS
- 2 PC CAST BASE COVERS
- TENONS OR FIXTURE DRILLINGS
- TOP CAP
- ELECTRICAL OUTLETS
- BANNER ARMS
- BREAKAWAY TRANSFORMER BASES
- BREAKAWAY CONNECTORS
- CUSTOM COLORS
- TAMPER RESISTANT HDWRE
- VIBRATION DAMPERS (IF REQUIRED)

THE ABOVE POLES ARE ONLY EXAMPLES OF OUR AVAILABLE LINE OF POLES. PLEASE CALL OUR ORDER DESK TO INQUIRE ABOUT YOUR REQUIREMENTS

2 PC. CAST BASE COVERS

AB-4 CAST BASE

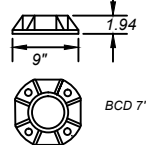

BASES WITH OTHER BCD ARE AVAILABLE
 PLEASE CONTACT OUR SALES DESK

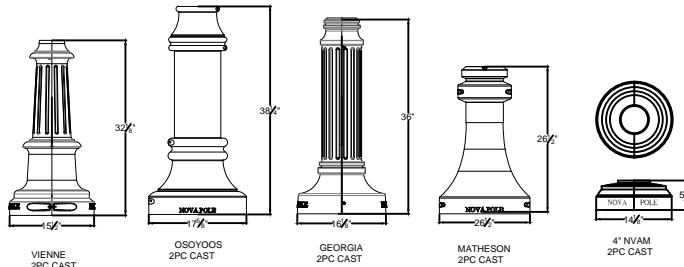

STRUCTURAL BASE COVERS

ASK OUR SALES DESK ABOUT OTHER AVAILABLE OPTIONS

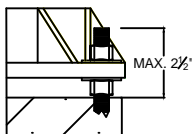

ANCHOR BOLTS PROJECTION

ANCHOR BOLTS

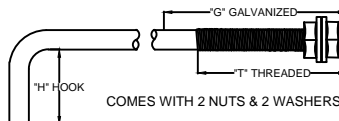

POLES ARE FABRICATED FROM 6063-T4 SEAMLESS ALUMINUM AND HEAT TREATED TO T6 AFTER WELDING...

WELDING CSA CERTIFIED TO CWB 47.1, 47.2

DIRECT BURIALS

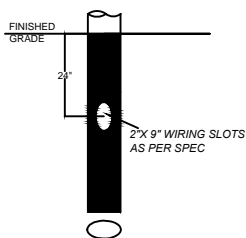

BELOW GRADE SECTION OVALIZED, POWDERCOATED, AND RUBBER PIPE WRAPPED

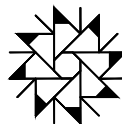

NOVA POLE Industries Inc.
 64 MA-TE-WAY PARK DRIVE
 Renfrew, On. Canada
 K7V 2L5

Tel: 613-431-7653
 Fax: 613-431-7655
 www.novapole.com

THIS DRAWING IS THE PROPERTY OF NOVA POLE INDUSTRIES INC. AND CONTAINS CONFIDENTIAL INFORMATION. REPRODUCTION OF ANY INFORMATION FROM IT WITHOUT EXPRESS WRITTEN PERMISSION OF NOVA POLE INDUSTRIES INC. IS NOT PERMITTED.